

GUIDE TO
STOURHEAD



Stourhead House

Aspiration
Inspiration
Creativity

Genius of the Place

Meet the makers of Stourhead

Stourhead as we know it today is the result of generations of visionaries, most especially Henry Hoare II who set about building a garden inspired by the works of art he'd collected while abroad on the Grand Tour of Europe. While his ambitious achievements earned him the nickname Henry 'the Magnificent', Hoare and his descendants employed the finest creative minds to help turn their ideas into reality.

As you explore the house look out for examples of the work of these creative geniuses

"The noble statue of an Hercules, executed by the ingenious Mr. Rysbrack, is sent to Stourton, the seat of Mr. Hoare, who has built a magnificent temple to receive it." So declared the Public Advertiser, on 12 January 1757. Look out for Rysbrack's working model in the Library



Mahogany bergère chair, by Thomas Chippendale the Younger (1749-1822). One of at least 163 pieces of furniture commissioned for Stourhead by Sir Richard Colt Hoare. Fine examples of Chippendale's work can be seen throughout the house.



'A very splendid Cabinet, embellished with precious stones, marbles, agates, &c. of every Description.' Visit the Cabinet Room to admire the work of the very finest Italian master-craftsmen



The Virgin and Child with Saint Anne after Leonardo Da Vinci's 1508 masterpiece – whilst not an original Leonardo, the brushwork in the background is exquisite



Look out for this symbol as you explore and meet more of the makers of Stourhead.

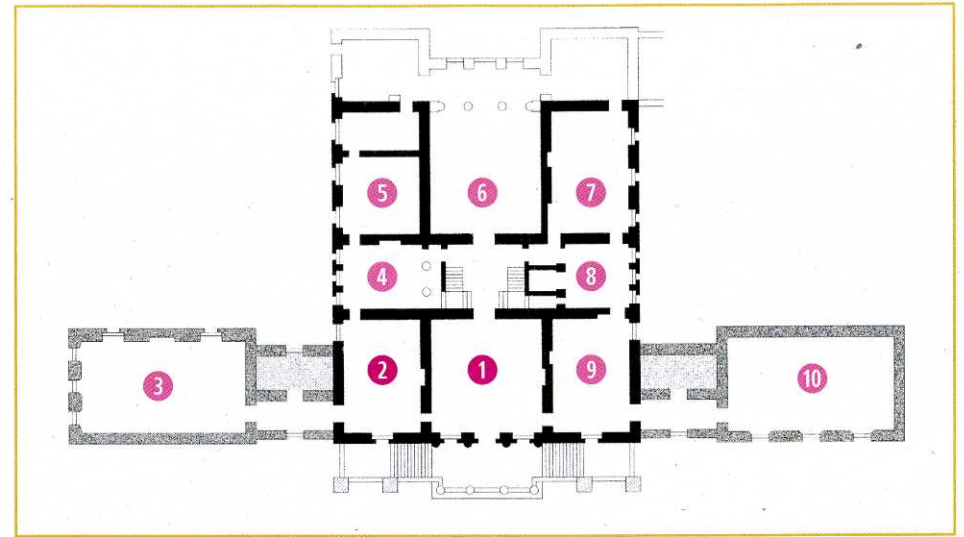

1 Entrance Hall: meet the makers of Stourhead

'Let us now introduce ourselves into the interior of this mansion, and by a handsome well-proportioned hall, being an exact cube of 30 feet. Its walls are chiefly covered with family portraits, a very appropriate decoration for the first entrance into a house... They remind us of the genealogy of our families, and recall to our minds the hospitality of its former inhabitants, and on the first entrance of the friend, or stranger, seem to greet them with a SALVE, or welcome.'

Sir Richard Colt Hoare, *A History of Modern Wiltshire*

2 Music Room: an escape from the city

Good Henry died before his new house was completed and was never able to enjoy life in his long dreamt of family home. Stourhead should have been his escape from the city but instead it was his widow, Jane Benson, who made the long and arduous journey from London to escape the hustle and bustle, spending time relaxing in the country with her son, Henry 'the Magnificent'.



